

**ELEVATION VIEWS**

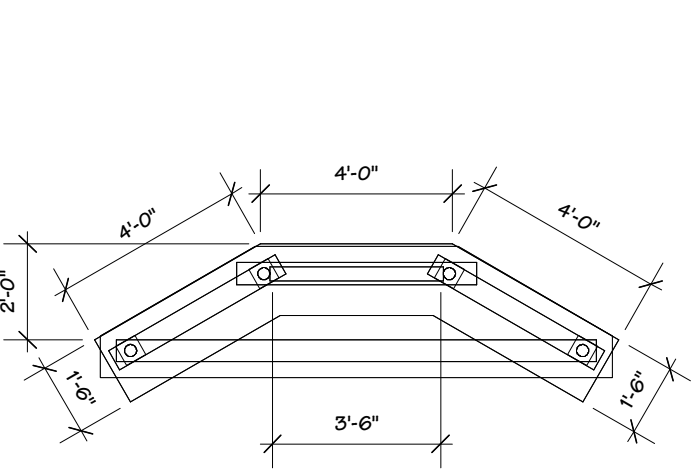

**KIOSK PLAN**

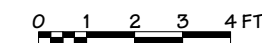
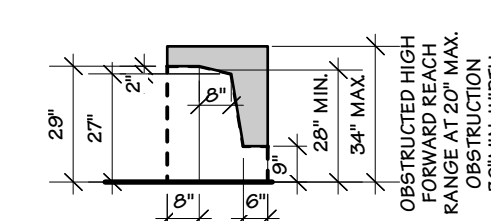
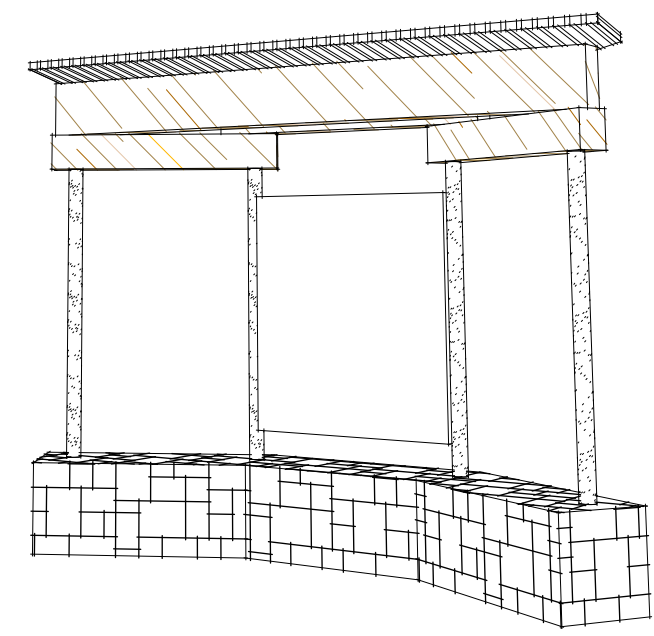

**11B-306 KNEE AND TOE CLEARANCE:**  
 WHERE SPACE BENEATH AN ELEMENT IS INCLUDED AS PART OF A CLEAR FLOOR OR GROUND SPACE OR TURNING SPACE, THE SPACE SHALL COMPLY WITH SECTION 11B-306.2 AND 11B-306.3.

**TOE KNEE CLEARANCE**



4" OF AGGREGATE CONCRETE W/ 3 PART ROCK @ MAX 3/8", 2 PART CEMENT, AND 2 PART LOCAL SAND, W/ "HEAVY" LOCAL SAND WASH BY HAND OR AS APPROVED BY OWNER OVER 6" COMPACTED GRAVEL CROSS SLOPE OF 1% (MAX. 2% / 1/4" / FT) RUNNING SLOPE LESS THAN 5% (1FT/20FT)

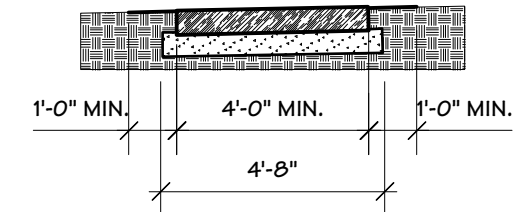

**PROPOSED TRAIL DETAIL**

CONFIRM ALL PAVING IN PUBLIC R.O.W. W/COUNTY ENGINEERING

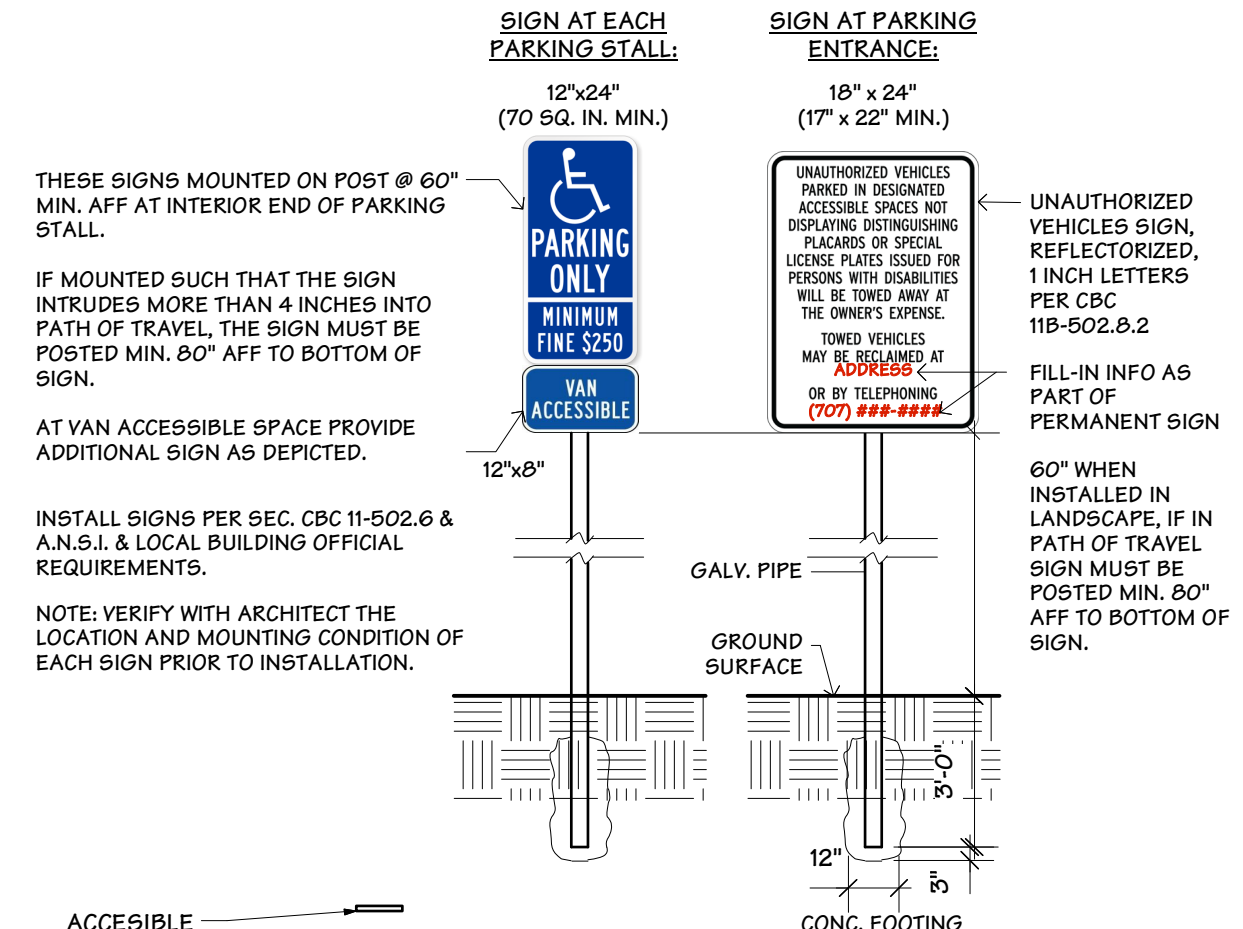

**THESE SIGNS MOUNTED ON POST @ 60" MIN. AFF AT INTERIOR END OF PARKING STALL.**  
 IF MOUNTED SUCH THAT THE SIGN INTRUDES MORE THAN 4 INCHES INTO PATH OF TRAVEL, THE SIGN MUST BE POSTED MIN. 80" AFF TO BOTTOM OF SIGN.  
 AT VAN ACCESSIBLE SPACE PROVIDE ADDITIONAL SIGN AS DEPICTED.  
 INSTALL SIGNS PER SEC. CBC 11-502.6 & A.N.S.I. & LOCAL BUILDING OFFICIAL REQUIREMENTS.  
 NOTE: VERIFY WITH ARCHITECT THE LOCATION AND MOUNTING CONDITION OF EACH SIGN PRIOR TO INSTALLATION.

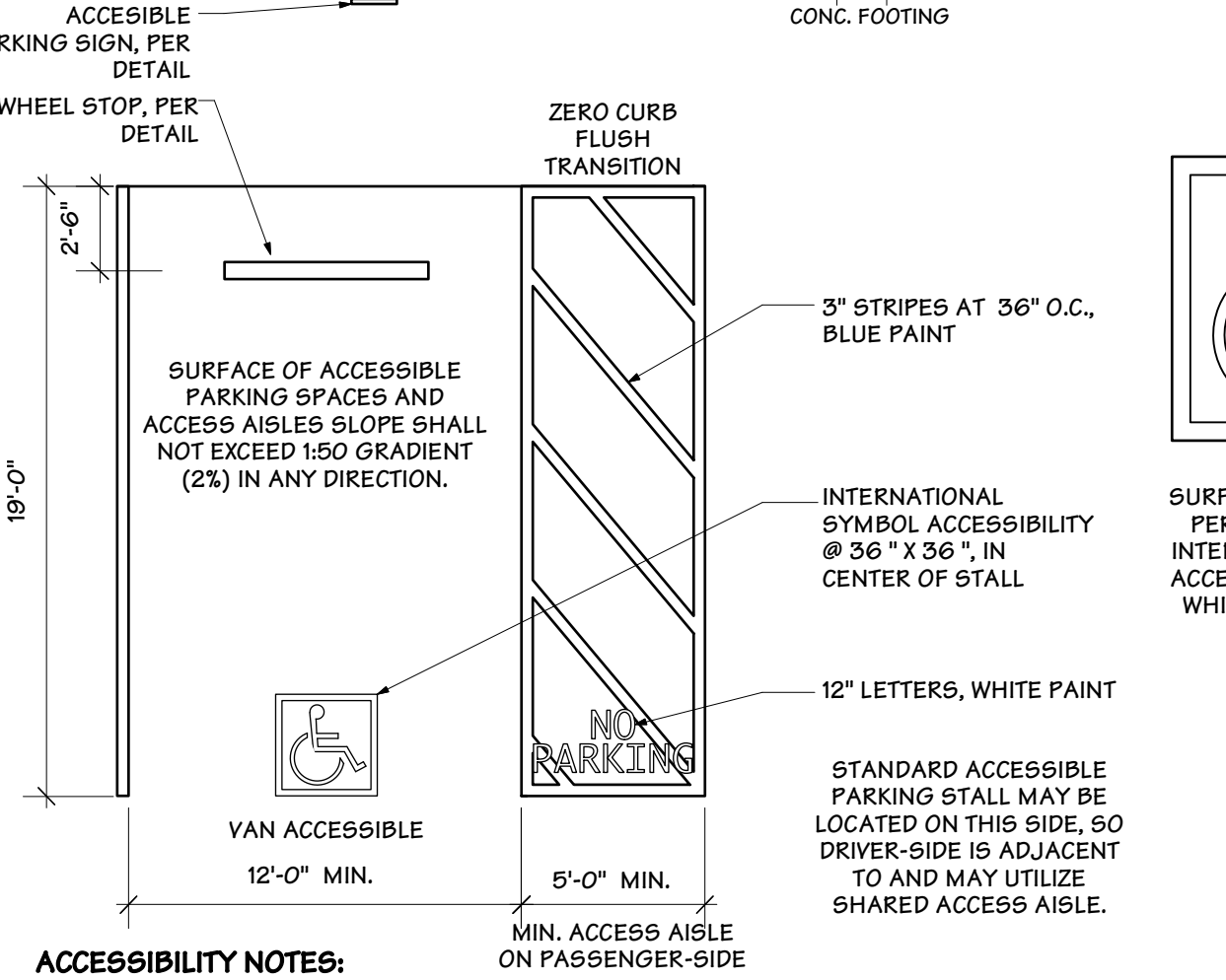

**ACCESSIBILITY NOTES:**

**OUTDOOR DEVELOPED AREAS SHALL COMPLY WITH SECTION 11B-246. (CA T24 11B-246.1)**  
 EXCEPTIONS  
 1. WHERE THE ENFORCING AGENCY FINDS THAT, IN SPECIFIC AREAS, THE NATURAL ENVIRONMENT WOULD BE MATERIALLY DAMAGED BY COMPLIANCE WITH THESE REGULATIONS, SUCH AREAS SHALL BE SUBJECT TO THESE REGULATIONS ONLY TO THE EXTENT THAT SUCH MATERIAL DAMAGE WOULD NOT OCCUR. (CA T24 11B-246.1 (EXC.1))  
 2. AUTOMOBILE ACCESS OR ACCESSIBLE ROUTES ARE NOT REQUIRED WHEN THE ENFORCING AGENCY DETERMINES COMPLIANCE WITH THIS CHAPTER WOULD CREATE AN UNREASONABLE HARDSHIP AS DEFINED IN CHAPTER 2, SECTION 202. (CA T24 11B-246.1 (EXC.2))

**BEACHES**  
 BEACHES SHALL BE ACCESSIBLE (CA T24 11B-246.3)

**DAY USE AREAS AND VISTA POINTS**  
 DAY USE AREAS, VISTA POINTS AND SIMILAR AREAS SHALL BE ACCESSIBLE. (CA T24 11B-246.4)

**PICNIC AREAS**  
 WHERE PICNIC TABLES ARE PROVIDED, AT LEAST 1 PICNIC TABLE, AND 1 ADDITIONAL TABLE FOR EACH 20 TABLES OR FRACTION THEREOF, SHALL BE ACCESSIBLE AND COMPLY WITH SECTION 11B-902. (CA T24 11B-246.5)  
**11B-902.2 CLEAR FLOOR OR GROUND SPACE.** A CLEAR FLOOR SPACE COMPLYING WITH SECTION 11B-305 POSITIONED FOR A FORWARD APPROACH SHALL BE PROVIDED. KNEE AND TOE CLEARANCE COMPLYING WITH SECTION 11B-306 SHALL BE PROVIDED.  
**11B-902.3 HEIGHT.** THE TOPS OF DINING SURFACES AND WORK SURFACES SHALL BE 28" MIN. AND 34" MAXIMUM ABOVE FINISH FLOOR OR GROUND.

**TRAILS AND PATHS (OUTSIDE OF PUBLIC RIGHT OF WAY)**  
 TRAILS, PATHS AND NATURE WALK AREAS, OR PORTIONS OF THEM, SHALL BE CONSTRUCTED WITH GRADIENTS PERMITTING AT LEAST PARTIAL USE BY WHEELCHAIR OCCUPANTS. (CA T24 11B-246.7)  
 BUILDINGS AND OTHER FUNCTIONAL AREAS SHALL BE SERVED BY PATHS OR WALKWAYS WITH FIRM AND STABLE SURFACES. (CA T24 11B-246.7)

**NATURE TRAILS (OUTSIDE OF PUBLIC RIGHT OF WAY)**  
 NATURE TRAILS AND SIMILAR EDUCATIONAL AND INFORMATIONAL AREAS SHALL BE ACCESSIBLE TO INDIVIDUALS WITH VISION IMPAIRMENTS BY THE PROVISION OF ROPE GUIDELINES, RAISED ARABIC NUMERALS AND SYMBOLS, OR OTHER SIMILAR GUIDE AND ASSISTANCE DEVICES. (CA T24 11B-246.8)

**PARKING LOTS**  
 PARKING LOTS SHALL COMPLY WITH SECTION 11B-208 AND 11B-502. (CA T24 11B-246.6)

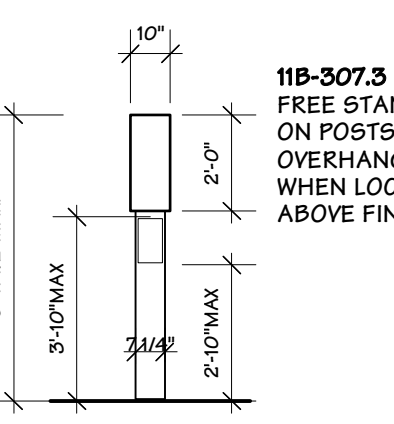

**WELCOME SIGN**

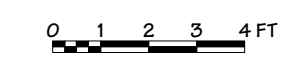

RELOCATED BENCH OR NEW CONCRETE BENCH PER OWNER  
 EXISTING INFORMATIONAL SIGN TO BE REPLACED BY NEW KIOSK (SEE DETAIL)  
 EXISTING BREAK IN SLOPE  
 EXISTING TRAIL  
 REMOVE EXISTING "SHOREBIRDS" SIGN PRESERVE INFO.  
 AT TRAIL ENTRANCE / HEAD ADD TWO TERRACED STEPS, INSTALL TO CONTROL EROSION  
 REMOVE EXISTING CONCRETE BENCH  
 VERIFY LOCATION OF 4FT CONC. TRAIL IN FIELD OWNERS REP. (TYPICAL)  
 NEW CONCRETE BENCH  
 EXISTING CONCRETE BENCH  
 EXISTING CONCRETE INFORMATIONAL SIGN  
 EXISTING ROCK WALLS  
 EXISTING BREAK IN SLOPE  
 EXISTING CYPRESS TREE  
 EXISTING BREAK IN SLOPE

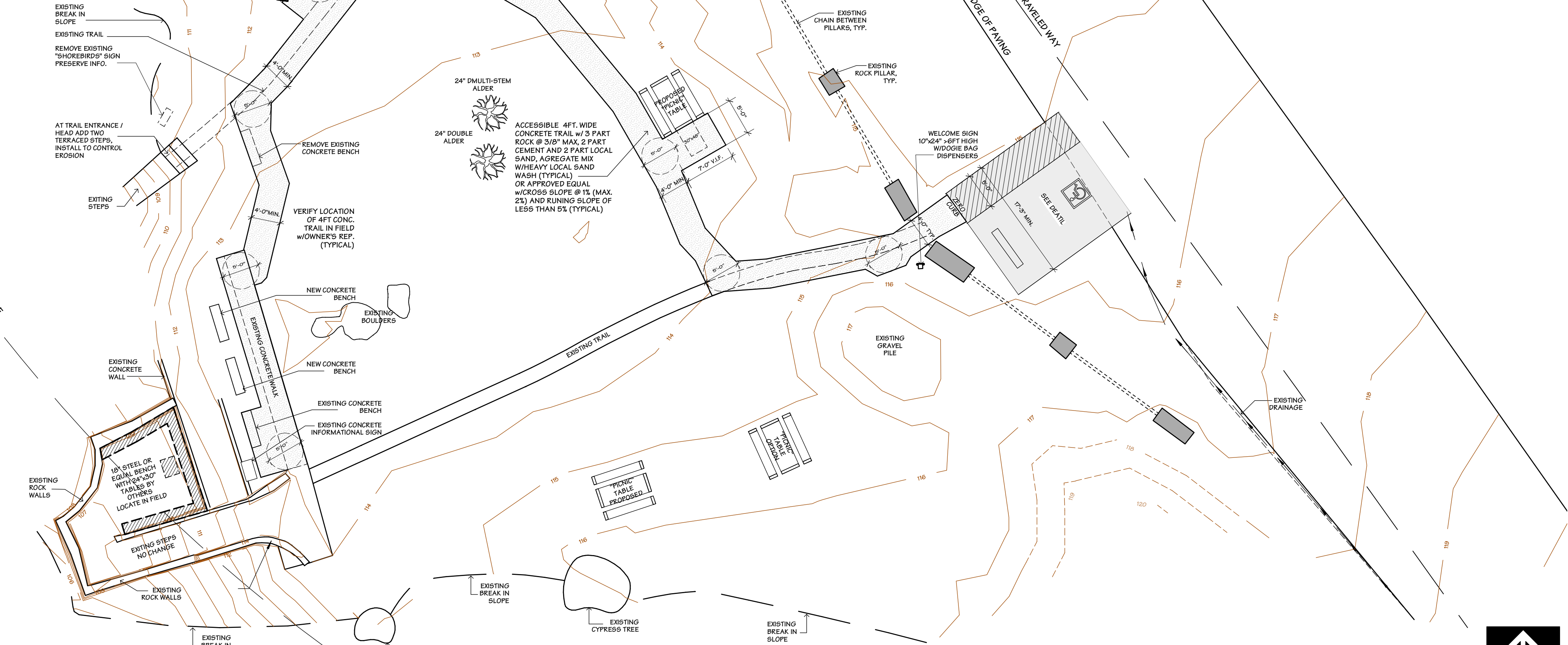

**PROPOSED SITE LAYOUT**

